

**Location**

Property is located within a specialist retailing area of low Harrogate. In the immediate area are such well-known occupiers as Betty's Cafe, Tenants Auctioneers, Hawico Cashmere, Toast, and numerous other quality retailers.

Description

The premise comprises a stone built Victorian building under a pitched slate covered roof.

This premise comprises a ground floor shop and basement.

Accommodation

The unit provides the following approximate dimensions and net floor areas:

Frontage 17' 10"

Shop Depth 32' 6"

Ground Floor 470 sq ft

Services

Mains electricity, gas, heating, water and drainage are connected to the property.

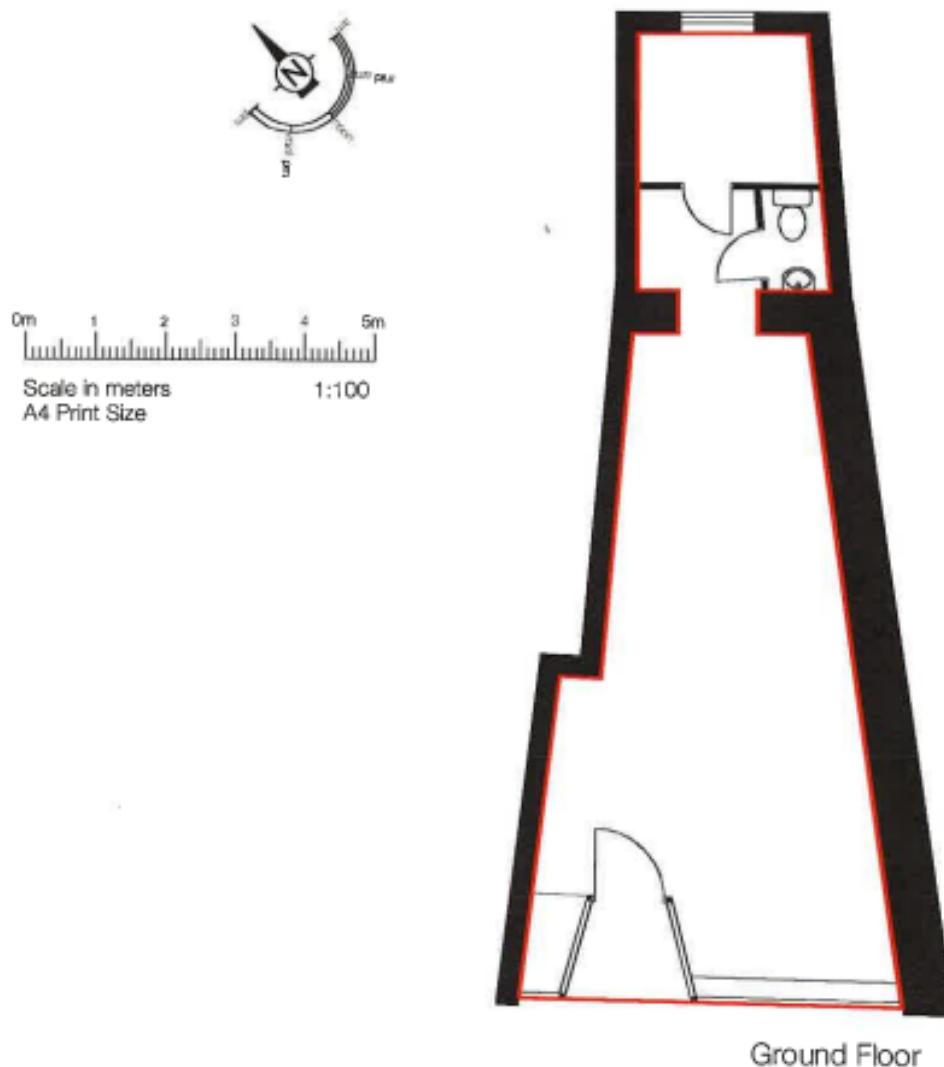

OS Map extract Crown Copyright
Metric Scale 1 : 1250
Location at Ground Floor Level

Planning

The property is not listed but is located in a conservation area.

EPC

126-150 **F** 131 | **F**

Please note, we have been informed by our EPC consultant that by changing all of the lightbulbs throughout the property we should be able to bring the EPC rating up to an acceptable rating.

Lease Terms

The property is offered on a five year lease term on internal repairing and insuring terms.

Rent

£20,000 per annum exclusive.

Rates

We understand that the retail unit is assessed for rating purposes as follows:

Rateable Value: £14,750
Rates Payable: £7,227.50

TO LET RETAIL

**25 MONTELLIER PARADE
HARROGATE
HG1 2TG**



VAT

All costs exclusive of VAT.

Legal Costs

Each party will be responsible for their own legal cost incurred in the transaction.

Further Information

David Waterhouse david@stapletonwaterhouse.com

Messrs. Stapleton Waterhouse for themselves and for the vendors or lessors of this property whose agents they are give notice that: (i) these particulars are set out as a general outline only for the guidance of intending purchasers or lessees and do not constitute, nor constitute part of, an offer or contract; (ii) all descriptions, dimensions, references to conditions and necessary permission for inspection or otherwise as to the correctness of each of them; (iii) no persons in the employment of Messrs. Stapleton Waterhouse has any authority to make or give any representation whatsoever in relation to this property; VAT Except as expressly stated in these particulars, all prices quoted (whether sale price, premium, rent or otherwise) shall in all cases be deemed to be exclusive of VAT and VAT will be added where applicable. Similarly, unless stated otherwise, any offer made will be deemed to be exclusive of VAT.

www.stapletonwaterhouse.com